

\$444,500 - 2020 Cavanagh Drive, Edmonton

MLS® #E4426611

\$444,500

4 Bedroom, 3.50 Bathroom, 1,164 sqft
Single Family on 0.00 Acres

Cavanagh, Edmonton, AB

Whatâ€™s better than a 3-bedroom half duplex in Cavanagh with a modern open-concept kitchen? One that also includes a fully finished basement with an extra bedroom, full bathroom, and a double detached garage! No need to compromiseâ€”thereâ€™s plenty of space for family visits and overnight guests. The open-concept main floor is perfect for entertaining, with a seamless flow from the living room to the kitchen and dining area. The eat-up island, featuring quartz countertops and stylish pendant lighting, provides extra prep space and casual seating. Upstairs, youâ€™ll find two spacious bedrooms, perfect for kids, guests, or a home office. The primary bedroom is a private retreat with large windows, natural light, and room for a king-sized bed. Cavanagh is minutes from the airport, ravine trails, parks, and major roads for easy city access!

Built in 2016

Essential Information

MLS® #	E4426611
Price	\$444,500
Bedrooms	4
Bathrooms	3.50
Full Baths	3
Half Baths	1

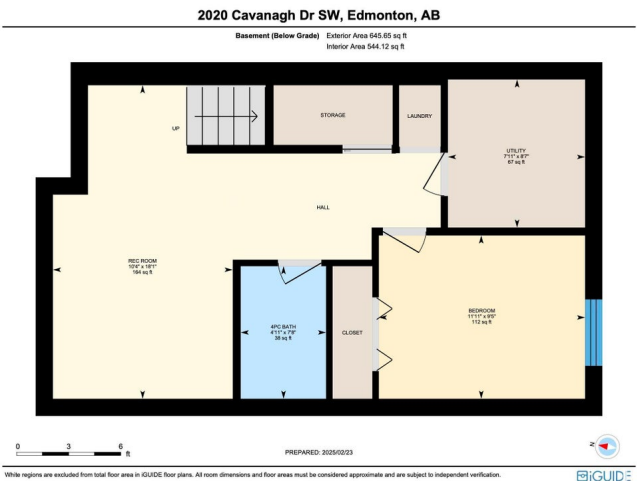

Square Footage	1,164
Acres	0.00
Year Built	2016
Type	Single Family
Sub-Type	Half Duplex
Style	2 Storey
Status	Active

Community Information

Address	2020 Cavanagh Drive
Area	Edmonton
Subdivision	Cavanagh
City	Edmonton
County	ALBERTA
Province	AB
Postal Code	T6W 3M6

Amenities

Amenities	On Street Parking, Carbon Monoxide Detectors, Ceiling 9 ft., Deck, Detectors Smoke, Vinyl Windows, See Remarks
Parking	Double Garage Detached

Interior

Interior Features	ensuite bathroom
Appliances	Dishwasher-Built-In, Dryer, Fan-Ceiling, Garage Control, Garage Opener, Microwave Hood Fan, Refrigerator, Stove-Electric, Washer, TV Wall Mount
Heating	Forced Air-1, Natural Gas
Stories	3
Has Basement	Yes
Basement	Full, Finished

Exterior

Exterior	Wood, Vinyl
Exterior Features	Airport Nearby, Back Lane, Fenced, Golf Nearby, Low Maintenance Landscape, Playground Nearby, Public Transportation, Schools, Shopping Nearby, See Remarks
Roof	Asphalt Shingles
Construction	Wood, Vinyl
Foundation	Concrete Perimeter

Additional Information

Date Listed	March 20th, 2025
Days on Market	28
Zoning	Zone 55

DATA IS DEEMED RELIABLE BUT IS NOT GUARANTEED ACCURATE BY THE REALTORS® ASSOCIATION OF EDMONTON. COPYRIGHT 2025 BY THE REALTORS® ASSOCIATION OF EDMONTON. ALL RIGHTS RESERVED.Trademarks are owned or controlled by the Canadian Real Estate Association (CREA) and identify real estate professionals who are members of CREA (REALTOR®, REALTORS®) and/or the quality of services they provide (MLS®, Multiple Listing Service®)

Listing information last updated on April 17th, 2025 at 1:17am MDT